

SOLO 250HT

Single-Roll Wrapper Household Towel

**We took the gold
in tissue wrap
speed records.**

Wraps up to 240 ppm

**Wraps household towel
and bathroom tissue**

**Poly and paper wrap
ready**

**Large reel diameter for
long production runs**

**Continuous motion
movements for less
vibration**

Very small footprint

**Quick and easy
change-overs from
paper to poly**

The InFINITY Solo 250HT is a high speed (up to 240 ppm) single roll wrapper that packs household towel AND bath tissue in poly and paper. This makes it the fastest single roll wrapper on the planet. Along with its speed, the Solo 250 carries a very small footprint while still being able to accommodate large reel diameters for long production runs. From taking rolls from the log saw to running them over the sealing belts, the Solo 250 HT operates with lightning speed and precision. This wrapper is a great way to increase your line's speed and performance. The Solo 250HT truly represents what we stand for, efficiency by design.

SOLO 250HT TECHNICAL DATA



HT Roll Dimensions

HT Diameter: Min - 90mm (3.54"), Max - 165mm (6.5")
HT Cut length: Max - 279mm (11")
HT Core diameter (inside): Min - 70mm (2.75"), Max - 76mm (3.00")

BRT Diameter: Min - 90mm (3.54"), Max - 140mm (5.5")
BRT Cut length: Min - 90mm (3.54"), Max - 115mm (6.5")
BRT Core diameter (inside): Min - 70mm (2.75"), Max - 76mm (3.00")

Reel Characteristics

Width: Min - 340 (13.38"), Max - 550mm (21.65")
Diameter: Max - 1200mm (47.25")

Wrap Material

Poly:
18 - 45 micron (0.7 - 1.77 mil)
Heat sealable polyethylene, density : 0.870 - 0.930 grs/cc

Machine Speed

BRT max speed (paper) is up to 200 packs/min
BRT max speed (poly) is up to 220 packs/min
HHT max speed (poly) is up to 220 packs/min
(Dependent upon packaging character)

Power / Air Requirements

	International Measurement	US Measurement
Air Consumption	284 NL/min	10 CFM
Air Pressure	5.52 bar	80 PSI
Main Power*	380 volt, 3 phase, 50 hertz	480 volt, 3 phase, 60 hertz
Installed Amps*	82 Amps	100 Amps
Control power	24 VDC	24 VDC

**Main power requirements are subject to change based on country.*

Changeover Time

Pack to Pack: 8 minutes
Poly Reel: 5 minutes
Poly to Paper: 80 minutes



Pack Configuration

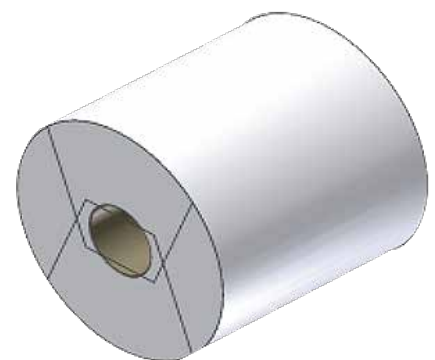

Corporate Headquarters:
2249 American Blvd
De Pere, WI 54115, USA
Tel: 920-965-0222

European Office :
Via Buozzi 55
40057 Cadriano di Granarolo, Bologna, Italy
Tel:+39-051-0560980

Infinity Machine & Engineering Corp.
info@infinitymec.com
www.infinitymec.com